

SPARE PARTS LIST/ERSATZTEILLISTE/LISTE DE PIÈCES DE RECHANGE

SULZER**AS 0840 S16/2 W&D,S18/2 W&D 60Hz Std.& FM**

Valid from Serial Number: 100 -

Issue of : 01/02/2021

Supersedes Issue :

Issue No. : 05

Drawing ref. Nr. : AN-S.12.029

Pos. No.	Part No.	Kit	Qty	Description	Benennung	Designation	Dimensions /Din	Comments	Price
1	31005033		1	Motorhousing	Motorgehäuse	Carcasse moteur			
2	11120829	AB	1	O-ring	O-ring	Joint torique	Ø32x3 DIN3771	Viton	
3	43025339		1	Cable EasyFit	Kabel EasyFit	Cable EasyFit	4x1.5	10m (D)	
3	43025340		1	Cable EasyFit	Kabel EasyFit	Cable EasyFit	4x1.5	20m (D)	
3	43025341		1	Cable EasyFit	Kabel EasyFit	Cable EasyFit	4x1.5	30m (D)	
3	43025841		1	Cable EasyFit	Kabel EasyFit	Cable EasyFit	4x1.5	10m (W)	
3	43025842		1	Cable EasyFit	Kabel EasyFit	Cable EasyFit	4x1.5	20m (W)	
3	43025843		1	Cable EasyFit	Kabel EasyFit	Cable EasyFit	4x1.5	30m (W)	
3	43025334		1	Cable EasyFit	Kabel EasyFit	Cable EasyFit	7x1.5	10m (W)	
3	43025335		1	Cable EasyFit	Kabel EasyFit	Cable EasyFit	7x1.5	20m (W)	
3	43025336		1	Cable EasyFit	Kabel EasyFit	Cable EasyFit	7x1.5	30m (W)	
3	43025323		1	Cable EasyFit	Kabel EasyFit	Cable EasyFit	7x1.5	10m (D)	
3	43025325		1	Cable EasyFit	Kabel EasyFit	Cable EasyFit	7x1.5	20m (D)	
3	43025327		1	Cable EasyFit	Kabel EasyFit	Cable EasyFit	7x1.5	30m (D)	
3	43025204		1	Cable	Kabel	Cable	14/7 SOW-A	10m (W)	
3	43025218		1	Cable	Kabel	Cable	14/7 SOW-A	20m (W)	
3	43025219		1	Cable	Kabel	Cable	14/7 SOW-A	30m (W)	
3	43025203		1	Cable	Kabel	Cable	14/7 SOW-A	10m (D)	
3	43025212		1	Cable	Kabel	Cable	14/7 SOW-A	20m (D)	
3	43025220		1	Cable	Kabel	Cable	14/7 SOW-A	30m (D)	
4	12180002		4(7)	Cable shoe	Flachsteckhülse	Cosse-câble		(7) for 7 core cable	
5	11210238		4(2)	Cylinder screw	Zyl.Blechschaube	Vis à tête plate	M8x30 DIN912	(2) EasyFit	
6	43025563		1	Cable	Kabel	Cable	4x1.5	10m (W/D)	
6	43025569		1	Cable	Kabel	Cable	4x1.5	20m (W/D)	
6	43025657		1	Cable	Kabel	Cable	4x1.5	30m (W/D)	
6	43025540		1	Cable	Kabel	Cable	7x1.5	10m (W)	
6	43025541		1	Cable	Kabel	Cable	7x1.5	20m (W)	
6	43025542		1	Cable	Kabel	Cable	7x1.5	30m (W)	
6	43025535		1	Cable	Kabel	Cable	7x1.5	10m (D)	
6	43025536		1	Cable	Kabel	Cable	7x1.5	20m (D)	
6	43025537		1	Cable	Kabel	Cable	7x1.5	30m (D)	
6	43025764-10		1	Cable	Kabel	Cable	7x1.5	10m (W)	
6	43025764-20		1	Cable	Kabel	Cable	7x1.5	20m (W)	
6	43025764-30		1	Cable	Kabel	Cable	7x1.5	30m (W)	
6	43025763-10		1	Cable	Kabel	Cable	7x1.5	10m (D)	
6	43025763-20		1	Cable	Kabel	Cable	7x1.5	20m (D)	
6	43025763-30		1	Cable	Kabel	Cable	7x1.5	30m (D)	
7	31325008		1	Cable cap	Kabeleinführung	Entree de cable	GG25 (Ø12)	Cable 4x1.5	
7	31320140		1	Cable cap	Kabeleinführung	Entree de cable	GG25 (Ø20)	Cable 4x1.5+3x0.5 Cable 7x1.5	
8	42015005		2	Washer	Scheibe	Rondelle	34x19.5x1.5	Cable SOW-A 14/7	
8	42015009		2	Washer	Scheibe	Rondelle	Ø34x18x1.5		
9	43075058	A	1	Cable seal	Kabdichtung	Joint de kabel	Ø34x11.5x29.5H	Cable 4x1.5	
9	43075056	B	1	Cable seal	Kabdichtung	Joint de kabel	Ø34x11.5x29.5H (viton)	Cable 4x1.5	

SPARE PARTS LIST/ERSATZTEILLISTE/LISTE DE PIÈCES DE RECHANGE

SULZER**AS 0840 S16/2 W&D,S18/2 W&D 60Hz Std.& FM**

Valid from Serial Number: 100 -

Issue of : 01/02/2021

Supersedes Issue :

Issue No. : 05

Drawing ref. Nr. : AN-S.12.029

Pos. No.	Part No.	Kit	Qty	Description	Benennung	Designation	Dimensions /Din	Comments	Price
9	43075048	A	1	Cable seal	Kabeldichtung	Joint de kabel	Ø34x16x29.5H	Cable 4x1.5+3x0.5 Cable 7x1.5	
9	43075057	B	1	Cable seal	Kabeldichtung	Joint de kabel	Ø34x16x29.5H (viton)	Cable 4x1.5+3x0.5 Cable 7x1.5 SO7RN-F OZ+	
9	43075049	A	1	Cable seal	Kabeldichtung	Joint de kabel	Ø34x16.8x29.5H	Cable 7x1.5 TL07RN-F	
9	43075028	A	1	Cable seal	Kabeldichtung	Joint de kabel	Ø34x13.8x29.5H	Cable 7x1.5	
9	43075068	B	1	Cable seal	Kabeldichtung	Joint de kabel	Ø34x16.8x29.5H (Viton)	Cable 7x1.5 TL07RN-F	
9	43075034	B	1	Cable seal	Kabeldichtung	Joint de kabel	Ø34x13.8x29.5H (Viton)	Cable 7x1.5	
9	43075029	A	1	Cable seal	Kabeldichtung	Joint de kabel	Ø34x18x29.5H	Cable SOW-A 14/7	
9	43075035	B	1	Cable seal	Kabeldichtung	Joint de kabel	Ø34x18x29.5H (viton)	Cable SOW-A 14/7	
10	12180044		4	Butt connection	St. verbinder	Connecteur	Ø1.0-2.5mm		
11	11060005		1	Support Washer	Tragscheibe	Rondelle	Ø20x28x2 DIN988		
12	11010048		1	Ball bearing	Kugellager	Roulement à billes	6304 Z DIN625		
13	11120817	A	1	O-ring	O-ring	Joint torique	Ø160x3 DIN3771		
13	11120870	B	1	O-ring	O-ring	Joint torique	Ø160x3 DIN3771	Viton	
14	11080010	AB	1	Circlip	Sicherungsring	Circlips	Ø52x2 DIN472		
15	11110001		1	Mechanical seal	Gleitringdichtung	Garniture mecanique	Ø20mm		
15	11110149		1	Mechanical seal	Gleitringdichtung	Garniture mecanique	Ø20mm (Viton)	Viton	
17	11210243		3	Cylinder screw	Zylinderschraube	Vis à tête cylindrique	M8x25 DIN912	1.4401	
19	11470072		1	Washer	Scheibe	Rondelle	Ø8.4 DIN9021	1.4301	
21	14990008		1	Shackle	Schäkel	Manille	DIN82101		
22	11010013		1	Ball bearing	Kugellager	Roulement à billes	6201 2RSR DIN625		
23	65005346		1	Stator	Wicklung	Stator	208/1/60	S16/2, S18/2	
23	65005339		1	Stator	Wicklung	Stator	230/1/60	S16/2, S18/2	
23	65005351		1	Stator	Wicklung	Stator	208/3/60	S16/2, S18/2	
23	65005353		1	Stator	Wicklung	Stator	230/3/60	S16/2, S18/2	
23	65005354		1	Stator	Wicklung	Stator	380/3/60	S16/2, S18/2	
23	65005341		1	Stator	Wicklung	Stator	460/3/60	S16/2, S18/2	
23	65005789		1	Stator	Wicklung	Stator	460/3/60 Without klixon	S16/2, S18/2	
23	65005454		1	Stator	Wicklung	Stator	575/3/60	S16/2, S18/2	
26	65015076		1	Rotor with shaft	Rotor mit Welle	Rotor avec arbre	1.4021		
26	65015080		1	Rotor with shaft	Rotor mit Welle	Rotor avec arbre	1.4401		
27	11130003	AB	1	Seal ring	Dichtung	Rondelle joint	Ø6x10 DIN7603		
28	11210253		1	Cylinder screw	Zylinderschraube	Vis à tête cylindrique	M6x10 DIN912		
29	11490020	AB	1	Seal washer	Verschlusscheibe	Rondelle joint	DIN470		
30	11070006	AB	1	Circlip	Sicherungsring	Circlip	Ø20x1.2 DIN471		
31	11210251		3	Cylinder screw	Zylinderschraube	Vis à tête cylindrique	M10x50 DIN912		
32	31155025		1	Bearing lid	Lager deckel	Couvercle palier	GG25	With FM DI-probe	
32	31155035		1	Bearing lid	Lager deckel	Couvercle palier	GG25	Std.Euro/US DI-probe	
33	11090009	AB	1	Lip seal	Wellendichtung	Joint à levres	Ø20x52x10 DIN3760		
34	11030046		0.43	Oil	Öl	Huile			
35	35075116		1	Impeller	Laufgrad	Roue	Ø110	S12/2, S13/2,S16/2	
35	35075108		1	Impeller	Laufgrad	Roue	Ø118	S18/2	
36	11070005	AB	1	Circlip	Sicherungsring	Circlip	Ø20x1.2 DIN471		

SPARE PARTS LIST/ERSATZTEILLISTE/LISTE DE PIÈCES DE RECHANGE

SULZER**AS 0840 S16/2 W&D,S18/2 W&D 60Hz Std.& FM**

Valid from Serial Number: 100 -

Issue of : 01/02/2021*Supersedes Issue* :*Issue No.* : 05*Drawing ref. Nr.* : AN-S.12.029

Pos. No.	Part No.	Kit	Qty	Description	Benennung	Designation	Dimensions /Din	Comments	Price
37	31055018		1	Volute	Kreiselkammer	Corps de pompe			
38	11630128		1	Impeller key	Paßfeder	Clavette	6x6x10 DIN6885		
39	21065022		1	Bottom plate	Bodenplatte	Plaque de base			
44	11650001	AB	1	Locking Washer	Klemmscheibe	Rondelle-frein	M8 PVC/NITR		
45	11260100		1	Lens Head Screw	Flachkopfschraube	Vis à tête plate	M8x10 DIN85		
46	11260104		1	Hexagonal screw	Sechskantschraube	Vis hexagonal	M5x10 DIN85 GV		
47	11500003		1	Locking washer	Sicherungsscheibe	Tole-frein	A5.1 DIN6797		
48	12180014		1	Cable shoe	Flachsteckhülse	Cosse-câble	Ø1.5-2.5mm		
49	43070326		1	Seal for DI	Dichtung für DI	Joint pour DI			
50	12180144		1	Round plug	Rundstecker	Fiche ronde	Ø4mm		
54	12120241		1	DI-probe	DI-electrode	Sonde DI	M12	FM	
55	42135000		1	DI-probe	DI-electrode	Sonde DI			
56	11080027		1	Circlip	Sicherungsscheibe	Circlip	Ø7x0.9mm DIN6799		
57	11060014		1	Support washer	Tragscheibe	Rondelle	Ø42x52x2.5 DIN988		
58	11100066		1	Mechanical seal	Gleitringdichtung	Garniture mecanique	Ø20mm	CARBON-CHROME	
59	11070006	AB	1	Circlip	Sicherungsring	Circlip	Ø20x1.2 DIN471		
60	12170032		1	Earth Clamp ID6					
61	11260099		1	Screw Slot HD			M6X12 DIN85		
62	11530016		1	Spring Washer			6mm DIN7980		
67	11210230		3	Cylinder screw	Zylinderschraube	Vis à tête cylindrique	M8x18 DIN912	1.4401	
68	42030101		3	Scerw Adjust			M12X25		
86	42570601		1	Base Ring	AS30 Transportable				
	61195072	A	1	Seal kit	Dichtungssatz	Jeu de joint complet			
	61195076	B	1	Seal kit	Dichtungssatz	Jeu de joint complet	Viton		

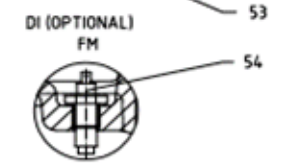
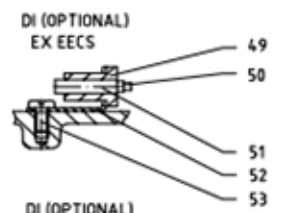
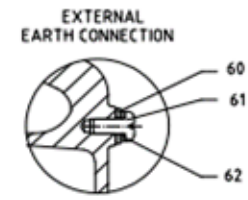
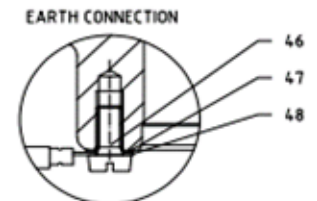
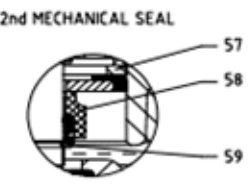
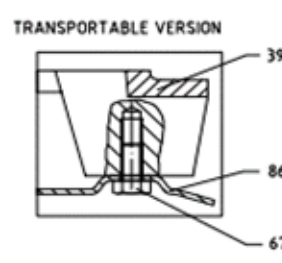
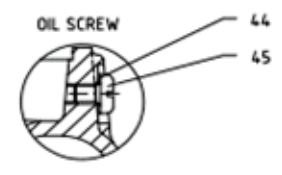
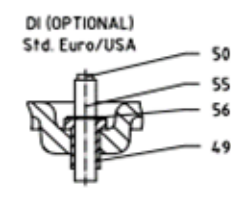
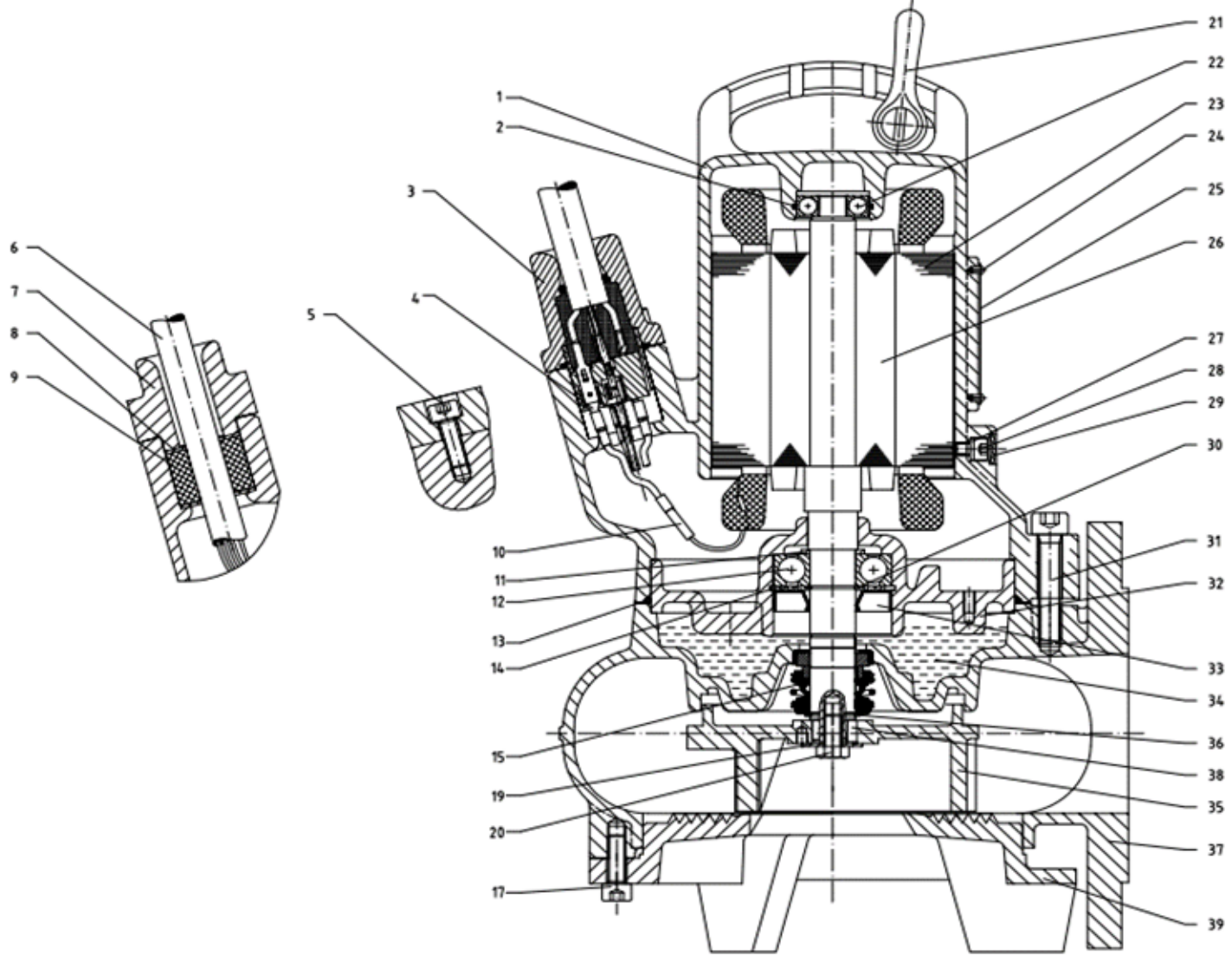

SULZER	SPARE PARTS LIST / ERSATZTEILLISTE	AN-S 12.29 -05
	LIST DE PIÈCES DE RECHANGE	CAD CODE: 0100001 / 0100002
	AS0840 S16-S18/2 60Hz	DATE: 25.05.90
	AS0840 S12-S17/2 50Hz	Product Code: 000